

Quick guide:

Inhaling with the **PARI SINUS**

Please ensure you read the Instructions For Use that come with the nebuliser and compressor, which give a more detailed description than this short guide. The instruction manual is included in the device package. If lost you can download the manual at www.pari.de/en or request by calling the PARI Service Center in Germany on telephone number +49 (0) 81 51-279 279.



1
Wash hands thoroughly before every session.



2a
Connect nebuliser, elbow piece and nasal joining piece.



2b
Fill with inhalation solution, close cap.

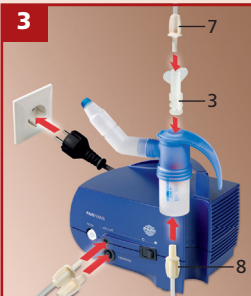

3
Attach vibration connection (3) to the nebuliser, connect to the compressor using the bolus tube (7). Connect nebuliser and compressor using the connection tubing (8).



4a
Sit in an upright position and relax. Block one nostril with the nose plug. Insert nebuliser in the other nostril. Switch the compressor on.

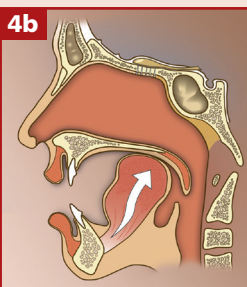

4b
Close the soft palate: Press tongue against roof of the mouth (as if pronouncing the letter "K") and pause. Hold breath. Allow treatment to work for about 10 sec; then take a break to breathe. Repeat action to resume treatment.



5
After half of the inhalation time has elapsed, change nostrils and continue as described in illustration 4b.



6
After completing the inhalation, switch compressor off and disconnect tubes from the nebuliser. To dry the tubes, switch the device on again.

Quick guide: Hygiene and maintenance of the **PARI SINUS** nebuliser

Please ensure you read the Instructions For Use that come with the nebuliser and compressor, which give a more detailed description than this short guide. The instruction manual is included in the device package. If lost you can download the manual at www.pari.de/en or request by calling the PARI Service Center in Germany on telephone number +49 (0) 81 51-279 279.

Please carry out the following after each use:



Cleaning

- Disassemble the nebuliser.
- Wash with warm tap water with dishwashing liquid.
- Rinse components thoroughly in running water.



Disinfecting

- Boil in a sufficient quantity of water for 5 minutes.
- or
- In a disinfectant (e.g., for baby bottles).



Drying

- Place components on a dry, lint-free cloth.
- When they have dried completely, keep components in a dry, dust-free place.



Maintenance: at least once a year

Air filter, nebuliser and connection tubing should be replaced every year. These components are included in the PARI LC SPRINT® SINUS Year Pack, which is available from your PARI dealer. Components may have to be replaced sooner if they are damaged or if contamination cannot be removed.



Specialists in effective inhalation



PARI GmbH

Moosstrasse 3 • 82319 Starnberg • Germany
Tel.: +49 (0) 8151-279 0 • Fax: (0) 8151-279 101
E-Mail: info@pari.de • www.pari.de