

The new eFlow[®]rapid with eBase Controller

New!
with Display.



eFlow[®]rapid
nebuliser system

www.eFlowrapid.info

PARI Pharma
Advancing Aerosol Therapies



**Modern Inhalation Therapy,
it's Twice as Fast**



eFlow[®]rapid enables quick and efficient inhalation significantly reducing the treatment burden¹.

The Main Advantages at a Glance:

- ➡ Short treatment times mean **better quality of life**
- ➡ Quiet running for **discrete use**
- ➡ Light, compact and portable. Can be run on either batteries or mains power for **greater mobility**
- ➡ Easy to clean, handset can be disinfected and autoclaved for the **highest standards of hygiene**
- ➡ New display **delivers feedback** during inhalation

1) Fischer R, Nährig S, Kerscher M, Huber RM: Inhalation with PARI eFlow[®]rapid reduces treatment burden significantly in adult CF patients without altering lung function, 2007.

Hygiene Tips

Short Guide to ensure Highest Standards of Hygiene at Home

Please refer to the Instructions for Use for more details

- ➡ **Clean**
Dismantle the nebuliser into its components. Rinse thoroughly in warm tap water with a little washing-up liquid immediately after every inhalation



- ➡ **Disinfect**
Disinfect the dismantled nebuliser and aerosol head at least once a day by putting them in a commercially-available baby bottle disinfecter for 15 minutes or alternatively by boiling them in distilled water for at least 5 minutes



- ➡ **Dry**
Allow to dry completely





- ➡ **Store**
Store in a clean, dry and hygienic place

Functionality Test for Aerosol Heads



Measure the time it takes for 2.5 ml of an isotonic saline solution (NaCl 0,9%) to be nebulised.

- ➡ 1. Should the measured time for nebulisation lie between 4 and 5 minutes, the aerosol head should be **cleaned** using the easycare cleaning aid 
- ➡ 2. Should the measured time for nebulisation be longer than 5 minutes after cleaning with easycare, then the aerosol head should be **changed** 

Components



* Aerosol chamber and medication reservoir are pre-fitted and cannot be taken apart.

New Functions

New display delivers feedback

The new eFlow®*rapid* with eBase controller can do much more. Its display delivers feedback during inhalation.



A Few Examples:



Battery charge level 50 %

-> Have new batteries on hand or operate with the power adapter connected

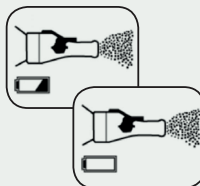

Cable connection to the control unit or on the nebuliser handset interrupted

-> Check cable connections

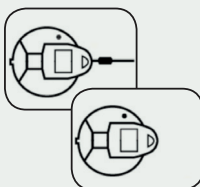

No medication added

-> Add medication

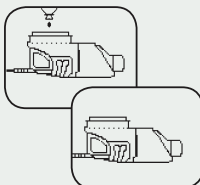

Good to know:

The new eBase controller can be used with the eFlow®*rapid* nebuliser handset for general use as well as with drug-specific nebuliser handsets (e.g. Altera® for Cayston®)



eFlow®*rapid*
nebuliser system

Order No. 178G1005

Replacement parts eFlow®*rapid* with eBase Controller
(control unit blue)



eFlow®*rapid* nebuliser handset 2.0
(incl. aerosol head)
Order No. 678G8222

eFlow®*rapid* aerosol head 2.0
Order No. 678B2620



Replacement parts eFlow®*rapid*
(control unit turquoise)



eFlow®*rapid* nebuliser handset
(incl. aerosol head)
Order No. 178G8012

eFlow®*rapid* aerosol head
Order No. 178B2603



Local Distributor